

DETAILS

| | | | |
|-------------------------|--------------|------------|-------------|
| Main Living | 3,577 sq ft* | Bedrooms | 5 |
| Upper Level | 1,433 | Bathrooms | 4/1 |
| TOTAL UNDER AIR | 5,010 | Garage | 2 |
| Garage | 701 | Year Built | 1957 |
| Covered Entry | 42 | Price | \$9,995,000 |
| Covered Lanai | 335 | | |
| TOTAL UNDER ROOF | 6,088 | | |
| Balcony | 274 | | |
| Lanai/Pool | 1,616 | | |
| Boat Dock | 676 | | |
| TOTAL AREA | 8,654 | | |

958
 SPYGLASS LANE
 PORT ROYAL | NAPLES, FL

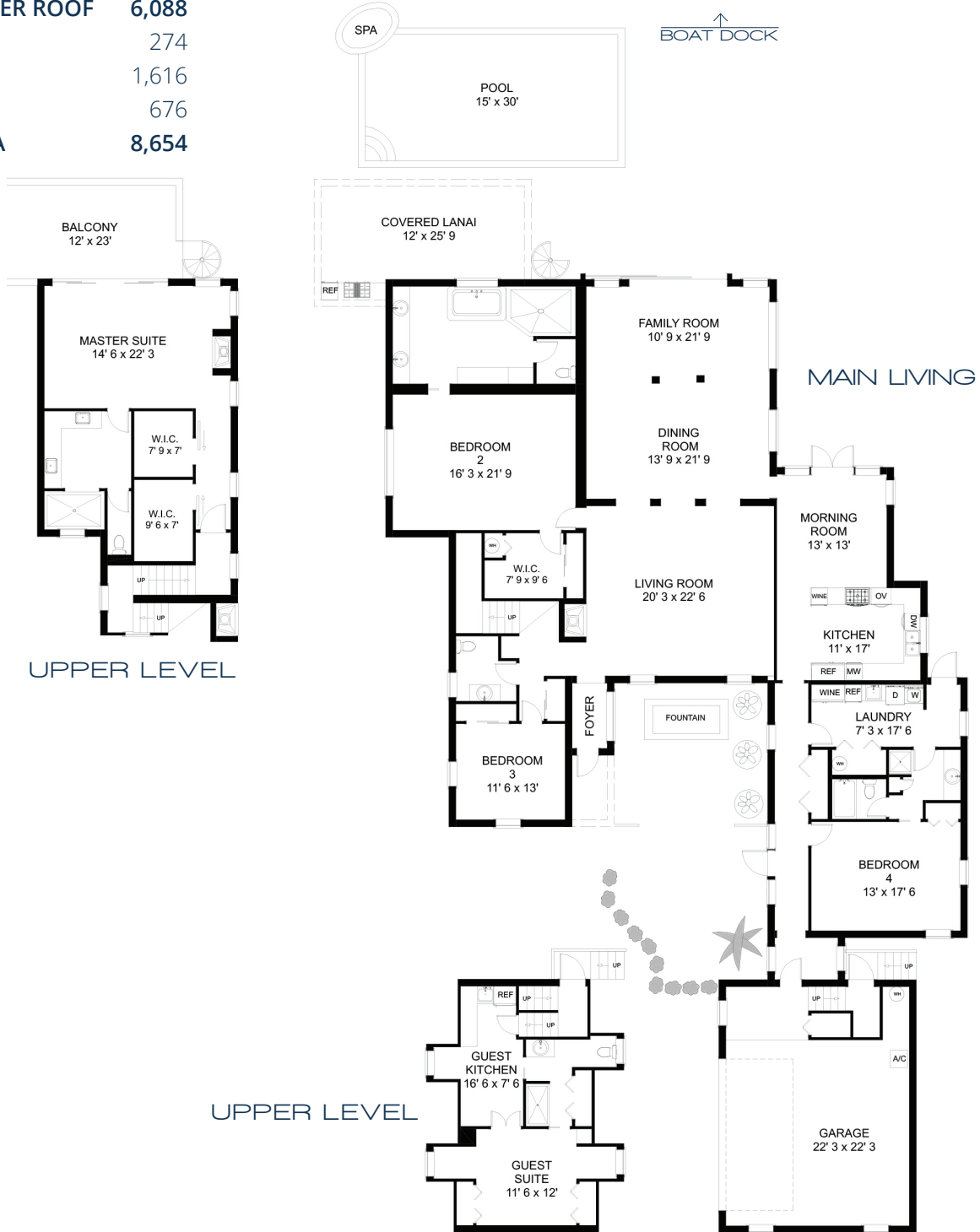

MICHAELAWLER.COM

Michael G. Lawler | 800 Harbour Drive | Naples, FL 34103 | 239.261.3939