

MGL

#1801

LE PARC
PARK SHORE - NAPLES

DETAILS

Bedrooms	2
Bathrooms	2/1
Parking Spaces	2
Year Built	1990
PRICE	\$2,195,000

TOTAL LIVING AREA 2,737 sq ft*

Perched on the white sands of the Gulf of Mexico, Naples is a world-class destination for eclectic dining, luxury shopping and countless cultural offerings. A golfer's paradise, it is home to more than 80 championship golf courses. From boating and fishing to biking and tennis. Neapolitans access the ultimate outdoor lifestyle. With a lively downtown, children's museum and water park, it has something for every taste. Meanwhile, swaying palms, stunning sunsets and idyllic nature preserves are the perfect recipe for relaxation.

MICHAELAWLER.COM

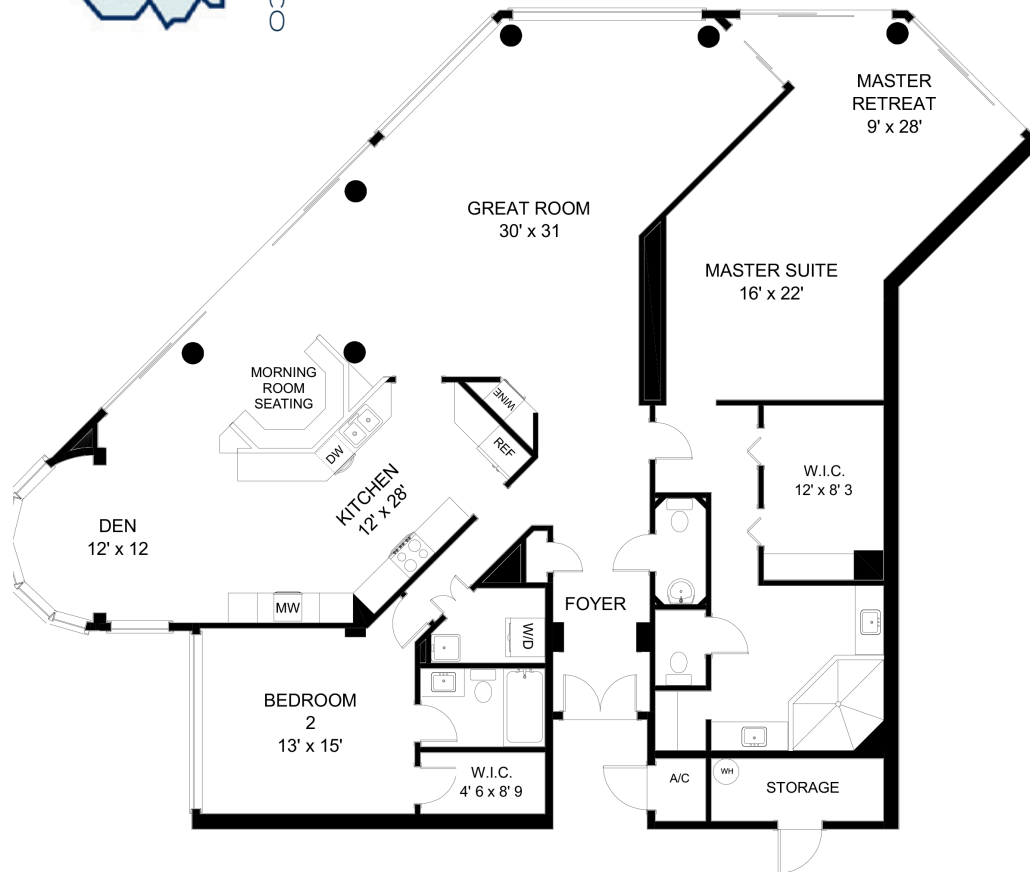

MICHAELAWLER.COM

Michael G. Lawler | 800 Harbour Drive | Naples, FL 34103 | 239.261.3939

